

# Emfil Stairs



Emfil Stair connected to Emfil Slab



Emfil Stair Lifting hooks

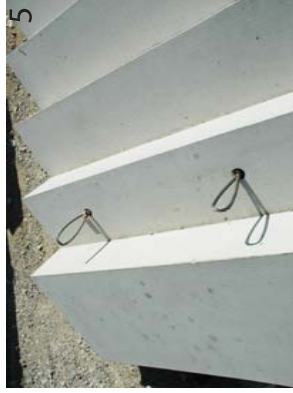

Emfil Spiral Stair



Emfil Stair fixed on Emfil landing

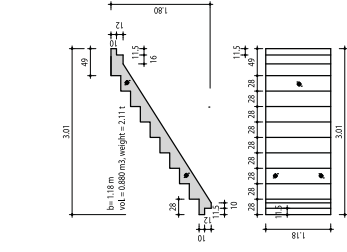
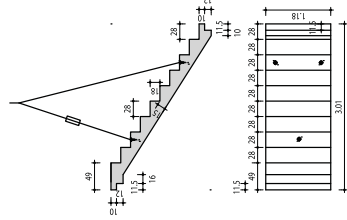
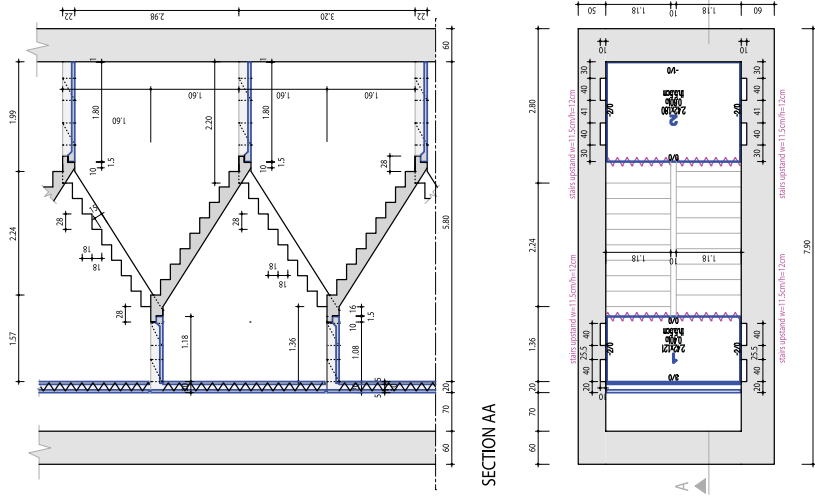

## ISOMETRIC VIEW

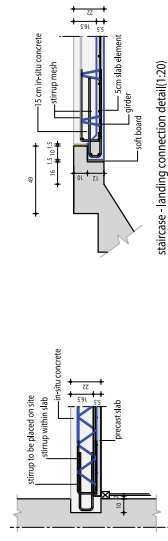

landing slab-wall connection detail(1:20)

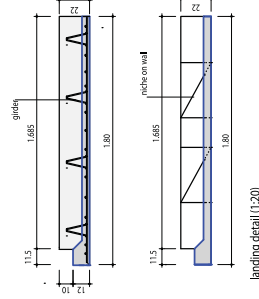

landing detail(1:20)

Legend:

element no.	dimension	weight
1	28	1.18
2	10	0.16
3	14	0.21
4	16	0.25
5	28	1.18
6	10	0.16
7	14	0.21
8	16	0.25
9	28	1.18
10	10	0.16
11	14	0.21
12	16	0.25
13	28	1.18
14	10	0.16
15	14	0.21
16	16	0.25
17	28	1.18
18	10	0.16
19	14	0.21
20	16	0.25
21	28	1.18
22	10	0.16
23	14	0.21
24	16	0.25
25	28	1.18
26	10	0.16
27	14	0.21
28	16	0.25
29	28	1.18
30	10	0.16
31	14	0.21
32	16	0.25
33	28	1.18
34	10	0.16
35	14	0.21
36	16	0.25
37	28	1.18
38	10	0.16
39	14	0.21
40	16	0.25
41	28	1.18
42	10	0.16
43	14	0.21
44	16	0.25
45	28	1.18
46	10	0.16
47	14	0.21
48	16	0.25
49	28	1.18
50	10	0.16
51	14	0.21
52	16	0.25
53	28	1.18
54	10	0.16
55	14	0.21
56	16	0.25
57	28	1.18
58	10	0.16
59	14	0.21
60	16	0.25
61	28	1.18
62	10	0.16
63	14	0.21
64	16	0.25
65	28	1.18
66	10	0.16
67	14	0.21
68	16	0.25
69	28	1.18
70	10	0.16
71	14	0.21
72	16	0.25
73	28	1.18
74	10	0.16
75	14	0.21
76	16	0.25
77	28	1.18
78	10	0.16
79	14	0.21
80	16	0.25
81	28	1.18
82	10	0.16
83	14	0.21
84	16	0.25
85	28	1.18
86	10	0.16
87	14	0.21
88	16	0.25
89	28	1.18
90	10	0.16
91	14	0.21
92	16	0.25
93	28	1.18
94	10	0.16
95	14	0.21
96	16	0.25
97	28	1.18
98	10	0.16
99	14	0.21
100	16	0.25

### STAIRCASE + DETAILS

Scale: 1:50

Job	EF
Location	RISK
Description	
Client	Emirates Filigran
Job No	general sample-3(stair-details)
Drawing No	F01
Date	04-01-09
Drawn	

If you have any questions please call:  
(+971)07 24 46 880

**Emirates Filigran** **الإمارات**

AL/Plan: 2008  
H/W = 297 / 420 (0.12m<sup>2</sup>)